

FLX SIGN

SOFT TOUCH.

FLXSIGN™ IS AN ADA SOLUTION FOR ENVIRONMENTS WHERE SAFETY IS A TOP CONSIDERATION.

With their lightweight, pliable materials and lack of sharp edges, these ADA-compliant signs meet the special safety requirements of certain markets including hospitals, nursing homes, prisons, K-12 schools, and hospitality. They're available in nine standard sizes for identification, regulatory and information signage.

FlxSign is not only safe and compliant; it's designed to be beautiful, too. Finish options are compatible with other 2/90 signs to help you create a consistent visual look throughout a facility. Sign and copy colors include 2/90's Prism and Designer colors. Customer colors are available. The look of decorative end caps can be added and custom shapes and sizes are available, too.

Need to update information? The changeable paper inserts provide a simple, sustainable way to change your signs. All copy and sign colors are subsurface to protect signs from vandalism and ensure a long performance.

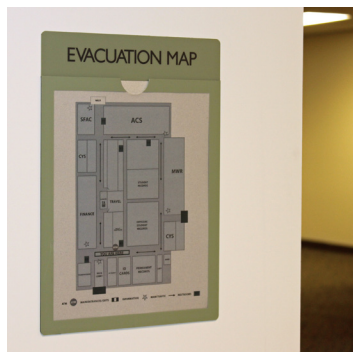

FLEXIBLE IN MORE WAYS THAN ONE!

- Window inserts allow graphics to be changed on-site.
- Safe design is lightweight and pliable with no sharp edges.
- Vacuum-formed material is durable and easy to clean.
- Raised tactile characters and domed Braille are ADA-compliant.
- All copy and sign colors are subsurface for vandal-resistance.
- Installs easily with no tools; tapes to wall surface.
- Economically priced for affordability.
- Wayfinding and custom signs are available.
- Laser-print templates are available at www.290signs.com.
- FlxSign™ profile is less than 1/32" thick.
- FlxSign™ with window profile is less than 1/8" thick.
- Available on GSA Contract.



F3x5 - FlxSign 3"x5"



F4x6 - Flx Sign 4"x6"



F6x6 - FlxSign 6"x6"

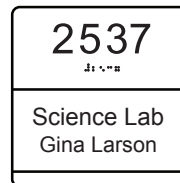

F6x6W3 - FlxSign 6"x6" with 3" Window



F6x6W2 - FlxSign 6"x6" with 2" Window

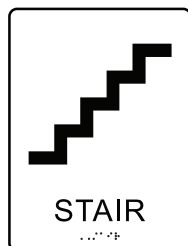

F8x6SYM - FlxSign 8"x6" with Symbol



F8x8SYM - FlxSign 8"x8" with Symbol

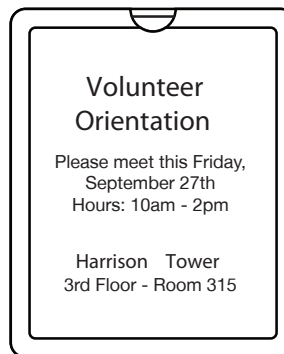

FPW - FlxSign Pocket Window 11.625"x9.5"

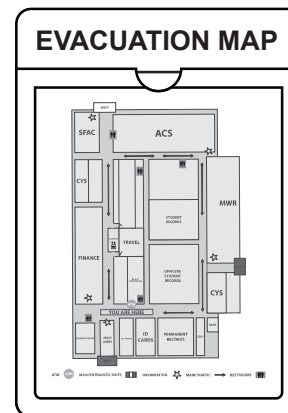

FPWH - FlxSign Pocket Window with Header 13.625"x9.5"

End Cap Detail Option

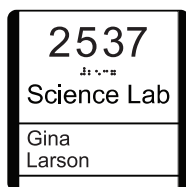

FE6x6W2 - FlxSign 6"x6" with 2" Window End Cap Detail

Paper Refills for Window Inserts

Catalog Number:	Description:	Qty Per Sheet:
WIP 2x6	2" x 6"	5
WIP 3x6	3" x 6"	3

Perforated Ream/500 Page Count Available.
Specify Standard Paper Colors: Cool Grey, Sand Putty, or White.

NOTE:
End Cap Detail Option Available for Upcharge
Not available for Pocket Windows