

FLX SIGN

SOFT TOUCH.

FLXSIGN™ IS AN ADA SOLUTION FOR ENVIRONMENTS WHERE SAFETY IS A TOP CONSIDERATION.

With their lightweight, pliable materials and lack of sharp edges, these ADA-compliant signs meet the special safety requirements of certain markets including hospitals, nursing homes, prisons, K-12 schools, and hospitality. They're available in nine standard sizes for identification, regulatory and information signage.

FlxSign™ is not only safe and compliant. It's designed to be beautiful, too. Finish options are compatible with other 2/90 signs to help you create a consistent visual look throughout a facility. Sign and copy colors are available in all standard non-metallic colors and color-match options, and the look of decorative end caps can be added. Custom shapes and sizes are available, too.

Need to update information? The changeable paper inserts provide a simple, sustainable way to change your signs. All copy and sign colors are subsurface to protect signs from vandalism and ensure a long performance.

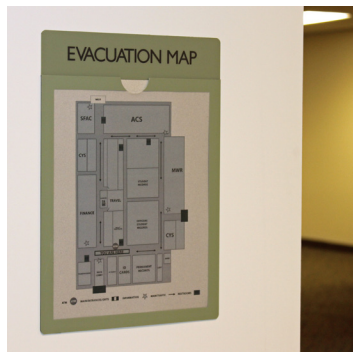

FLEXIBLE IN MORE WAYS THAN ONE!

- Window inserts allow graphics to be changed on-site
- Safe design is lightweight and pliable with no sharp edges
- Vacuum-formed material is durable and easy to clean
- Raised tactile characters and domed Braille are ADA-compliant
- All copy and sign colors are subsurface for vandal-resistance
- Installs easily with no tools; tapes to wall surface
- Economically priced for affordability
- Wayfinding and custom signs are available
- Laser-print templates are available at www.290signs.com
- FlxSign™ profile is less than 1/32" thick
- FlxSign™ with window profile is less than 1/8" thick
- Available on GSA Contract

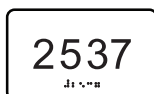

F3x5 - FlxSign 3"x5"



F4x6 - Flx Sign 4"x6"



F6x6 - FlxSign 6"x6"

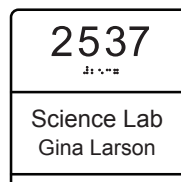

F6x6W3 - FlxSign 6"x6" with 3" Window

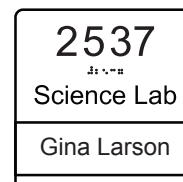

F6x6W2 - FlxSign 6"x6" with 2" Window

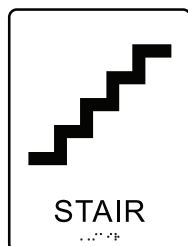

F8x6SYM - FlxSign 8"x6" with Symbol



F8x8SYM - FlxSign 8"x8" with Symbol

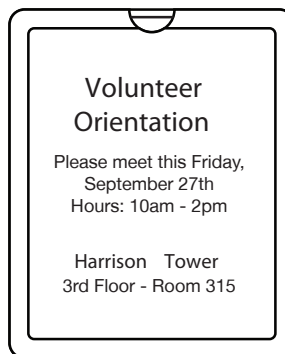

FPW - FlxSign Pocket Window 11.625"x9.5"

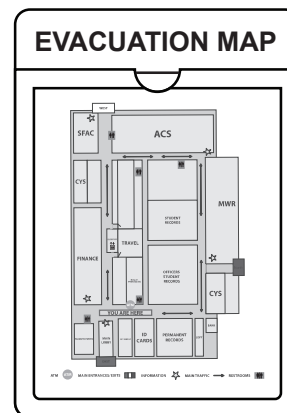

FPWH - FlxSign Pocket Window with Header 13.625"x9.5"

Paper Refills for Window Inserts

End Cap Detail Option

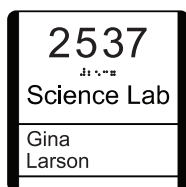

FE6x6W2 - FlxSign 6"x6" with 2" Window End Cap Detail

Paper Refills for Window Inserts

Catalog Number:	Description:	Qty Per Sheet:
WIP 2x6	2" x 6"	5
WIP 3x6	3" x 6"	3

Perforated Ream/500 Page Count Available.
Specify Standard Paper Colors: Cool Grey, Sand Putty, or White.

NOTE:
End Cap Detail Option Available for Upcharge
Not available for Pocket Windows